

OPzV Series Battery

SPACEFLIGHT OPzV Series battery is Tubular GEL battery, designed with an innovative tubular plates which provide greater capacity and enhanced cycle life. The battery has been specifically designed for longer life, greater reliability and strong resilience to high temperature making them ideal for critical power applications and energy storage.

Applications

- Solar and wind power systems
- Uninterruptible power supplies
- Communication systems
- Telecommunication systems
- Emergency Power Systems

General Features

- 20 years design life(25 °C)
- Non-spillable construction
- Sealed and maintenance-free
- Advanced tubular positive plates
- Excellent recovery from deep discharge
- Longer Life and low self-discharge

Standards

- Compliance with IEC, BS, JIS and EU standards.
- UL, CE Certified
- ISO45001,ISO9001 and ISO14001 certified production facilities

Specifications

Rated Voltage	2V	
Nominal Capacity	2000Ah	(C ₁₀ , 1.80V)
Approx Weight	153.0kg±3%(337.31lbs)	
Terminal	F28	
Rated Capacity(25°C)	2490 Ah	(100hr,24.9A,1.85V)
	2448 Ah	(48hr,51.0A,1.85V)
	2000 Ah	(10hr,200A,1.80V)
	1500 Ah	(3hr,500A,1.80V)
Max.Discharge/Charge Current	10000A(5s)/500A	
Max.Short Circuit Current	10048A	
Internal Resistance(25°C)	Approx 0.22mΩ	
Operating Temp.Range	Discharge	-20~60°C(-4~140°F)
	Charge	-10~50°C(14~122°F)
	Storage	-20~60°C(-4~140°F)
Nominal operating temperature	25±5°C	
Charge Voltage @25°C(77°F)	Cycle Use	Initial Charging Current less than 500A. Voltage 2.4V~2.45V at 25°C(77°F)Temp. Coefficient -5mV/°C
	Standby Use	Initial Charging Current less than 500A. Voltage 2.25V~2.27V at 25°C(77°F)Temp. Coefficient -3mV/°C
Temperature effects on capacity	40°C (104°F)	103%
	25°C (77°F)	100%
	0°C (32°F)	86%
	-15°C (5°F)	65%
Self Discharge(25°C)	Capacity after 3 months storage	91%
	Capacity after 6 months storage	82%
	Capacity after 12 months storage	65%



Dimensions

unit:mm

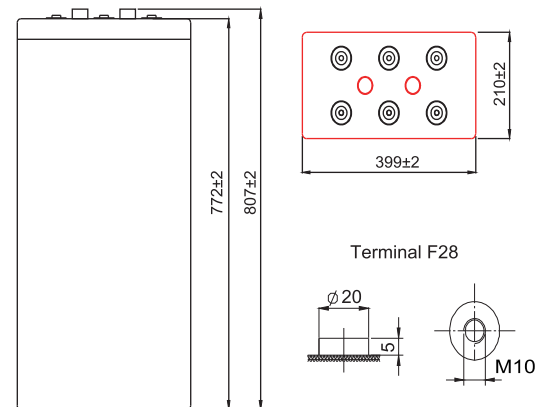

Length	399±2mm (15.7 inches)
Width	210±2mm (8.26 inches)
Container Height	772±2mm (30.4 inches)
Total Height	807±2mm (31.8 inches)

Battery Construction

Component	Positive plate	Negative plate	Container	Safety valve	Terminal	Separator	Electrolyte
Raw material	Lead dioxide	Lead	ABS(UL94-HB) or FR(UL94-V0)	Rubber	Copper	PVC-SiO ₂	Fumed Silicon

Constant Current Discharge (Amperes) at 25°C(77°F)

E.V/Time	15min	30min	1h	3h	5h	10h	24h	48h	100h
1.65V	2510	1880	1178	537	375	/	/	/	/
1.70V	2275	1705	1112	525	356	/	/	/	/
1.75V	2150	1622	1045	514	348	204	/	/	/
1.80V	2018	1532	1081	500	334	200	/	/	/
1.85V	1888	1391	980	488	326	189	93.0	51.0	24.9

Constant Power Discharge (Watts/cell) at 25°C(77°F)

E.V/Time	15min	30min	1h	3h	5h	10h	24h	48h	100h
1.65V	4905	3662	2360	1072	752	/	/	/	/
1.70V	4446	3305	2214	1043	715	/	/	/	/
1.75V	4192	3162	2082	1019	695	405	/	/	/
1.80V	3942	2980	2028	998	666	398	/	/	/
1.85V	3690	2715	1878	975	648	378	183	103	50.1

Note: The above characteristics data are average values obtained Within three charge/discharge cycles not the minimum.

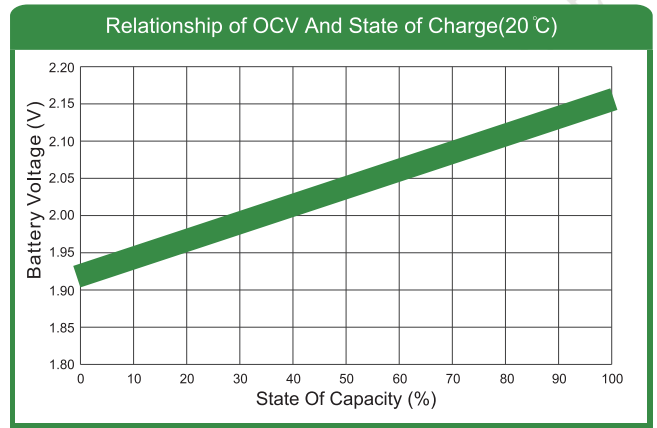
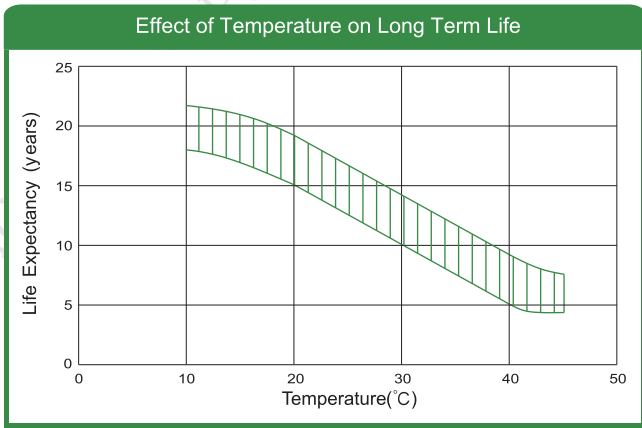
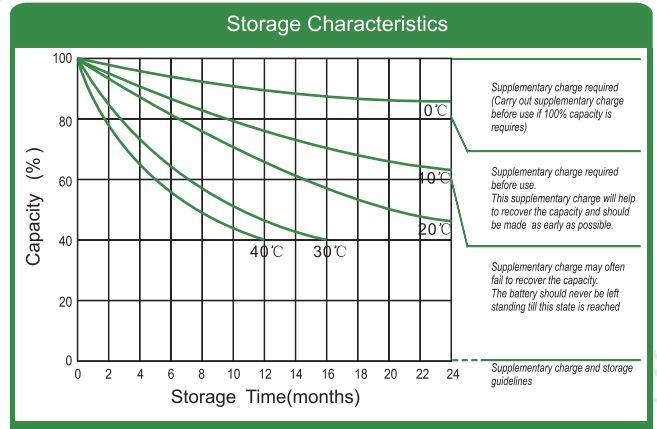
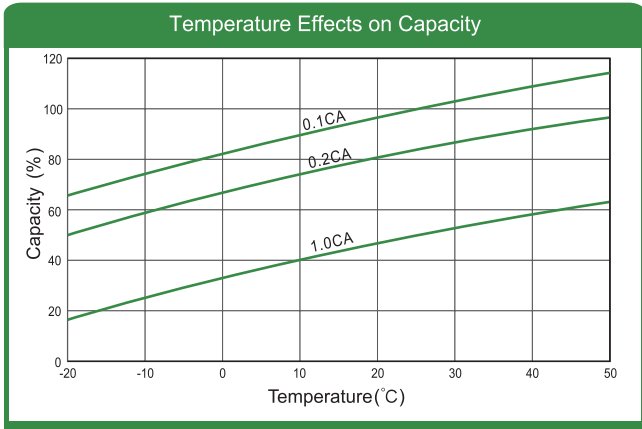
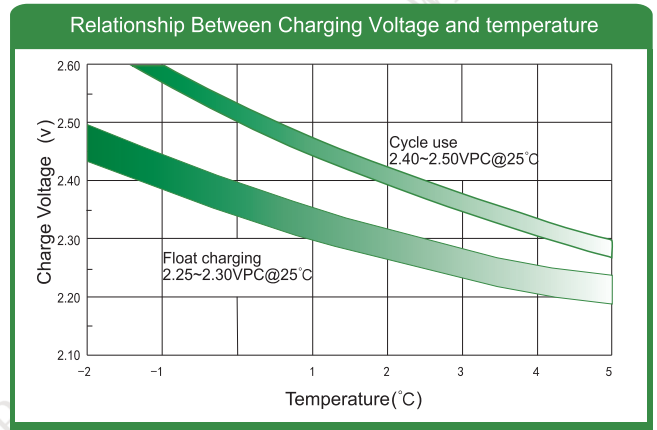
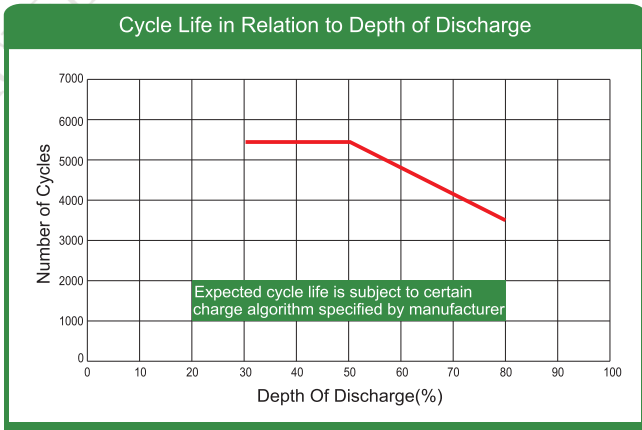
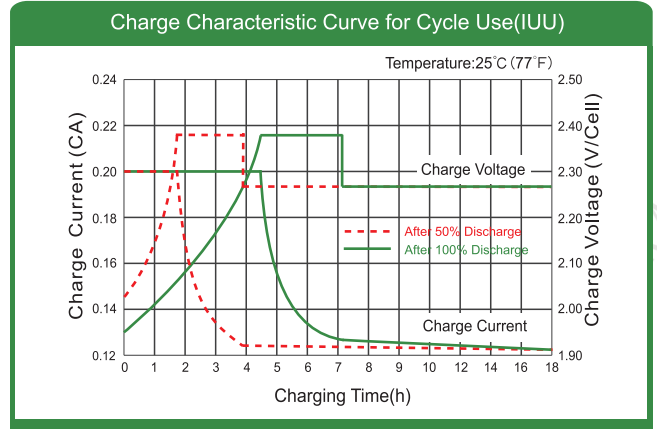
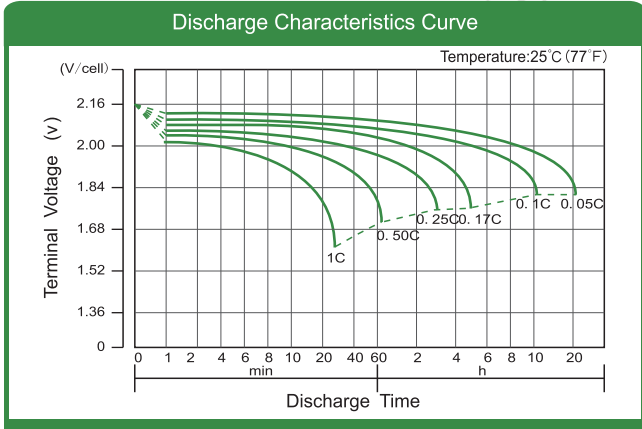

Factory address: Fukang Industrial Zone, Longnan, Ganzhou, Jiangxi Province, China.
 Shenzhen Office: RM208-210, Building D, Tongju industrial Park, No.4, Longping West Road, Longgang District, Shenzhen.
 TEL: +86-755-28288189 sales@sfbattery.com www.sfbattery.com