

## 5 OPzV350(2V350Ah)

### OPzV Series Battery

SPACEFLIGHT OPzV Series battery is Tubular GEL battery, designed with an innovative tubular plates which provide greater capacity and enhanced cycle life. The battery has been specifically designed for longer life, greater reliability and strong resilience to high temperature making them ideal for critical power applications and energy storage.

### Applications

- Solar and wind power systems
- Uninterruptible power supplies
- Communication systems
- Telecommunication systems
- Emergency Power Systems

### General Features

- 20 years design life(25 °C)
- Non-spillable construction
- Sealed and maintenance-free
- Advanced tubular positive plates
- Excellent recovery from deep discharge
- Longer Life and low self-discharge

### Standards

- Compliance with IEC, BS, JIS and EU standards.
- UL, CE Certified
- ISO45001,ISO9001 and ISO14001 certified production facilities

### Specifications

|                                 |                                  |  |
|---------------------------------|----------------------------------|--|
| Rated Voltage                   | 2V                               |  |
| Nominal Capacity                | 350Ah                            | (C <sub>10</sub> , 1.80V)  |
| Approx Weight                   | 28.5kg±3%(62.83lbs)              |  |
| Terminal                        | F28                              |  |
| Rated Capacity(25°C)            | 426 Ah                           | ( 120hr,3.55A,1.85V)   |
|                                 | 424 Ah                           | (100hr,4.24A,1.85V)  |
|                                 | 350 Ah                           | (10hr,35A,1.80V)   |
|                                 | 262.5 Ah                         | (3hr,87.5A,1.80V)  |
| Max.Discharge/Charge Current    | 1750A(5s)/87.5A                  |  |
| Max.Short Circuit Current       | 3410A                            |  |
| Internal Resistance(25°C)       | Approx 0.8mΩ                     |  |
| Operating Temp.Range            | Discharge                        | -20~60°C(-4~140°F)   |
|                                 | Charge                           | -10~50°C(14~122°F)   |
|                                 | Storage                          | -20~60°C(-4~140°F)   |
| Nominal operating temperature   | 25±5°C                           |  |
| Charge Voltage @25°C(77°F)      | Cycle Use                        | Initial Charging Current less than 87.5A. Voltage 2.4V~2.45V at 25°C(77°F)Temp. Coefficient -5mV/°C  |
|                                 | Standby Use                      | Initial Charging Current less than 87.5A. Voltage 2.25V~2.27V at 25°C(77°F)Temp. Coefficient -3mV/°C |
| Temperature effects on capacity | 40°C (104°F)                     | 103%   |
|                                 | 25°C (77°F)                      | 100%   |
|                                 | 0°C (32°F)                       | 86%  |
|                                 | -15°C (5°F)                      | 65%  |
| Self Discharge(25°C)            | Capacity after 3 months storage  | 91%  |
|                                 | Capacity after 6 months storage  | 82%  |
|                                 | Capacity after 12 months storage | 65%  |



### Dimensions

unit:mm

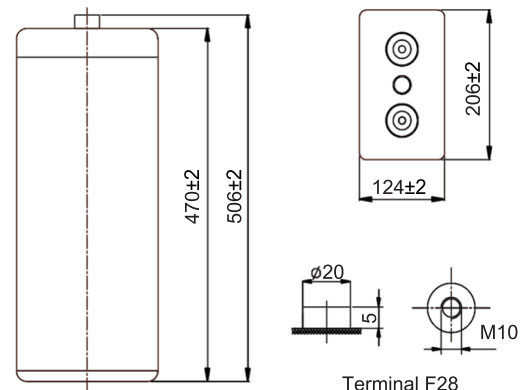

|                  |                       |
|------------------|-----------------------|
| Length           | 206±2mm (8.11 inches) |
| Width            | 124±2mm (4.88 inches) |
| Container Height | 470±2mm (18.5 inches) |
| Total Height     | 506±2mm (19.9 inches) |

### Battery Construction

| Component    | Positive plate | Negative plate | Container                   | Safety valve | Terminal | Separator            | Electrolyte   |
|--------------|----------------|----------------|-----------------------------|--------------|----------|----------------------|---------------|
| Raw material | Lead dioxide   | Lead           | ABS(UL94-HB) or FR(UL94-V0) | Rubber       | Copper   | PVC-SiO <sub>2</sub> | Fumed Silicon |

### Constant Current Discharge (Amperes) at 25°C(77°F)

| E.V/Time | 30min | 1h  | 3h   | 5h   | 10h  | 20h  | 48h  | 100h | 120h |
|----------|-------|-----|------|------|------|------|------|------|------|
| 1.65V    | 329   | 207 | 94.0 | 66.2 | 35.8 | 18.8 | /    | /    | /    |
| 1.70V    | 299   | 194 | 91.2 | 62.7 | 35.7 | 18.8 | 8.58 | /    | /    |
| 1.75V    | 284   | 182 | 90.0 | 61.2 | 35.7 | 18.7 | 8.54 | /    | /    |
| 1.80V    | 268   | 179 | 87.5 | 58.6 | 35.0 | 18.6 | 8.47 | /    | /    |
| 1.85V    | 243   | 171 | 85.6 | 57.2 | 33.1 | 17.6 | 8.30 | 4.24 | 3.55 |

### Constant Power Discharge (Watts/cell) at 25°C(77°F)

| E.V/Time | 30min | 1h  | 3h  | 5h  | 10h  | 20h  | 48h  | 100h | 120h |
|----------|-------|-----|-----|-----|------|------|------|------|------|
| 1.65V    | 642   | 411 | 187 | 132 | 71.5 | 37.8 | /    | /    | /    |
| 1.70V    | 584   | 387 | 181 | 125 | 71.0 | 37.5 | 17.3 | /    | /    |
| 1.75V    | 553   | 362 | 179 | 122 | 71.0 | 37.5 | 17.2 | /    | /    |
| 1.80V    | 522   | 355 | 174 | 117 | 69.7 | 37.1 | 17.1 | /    | /    |
| 1.85V    | 474   | 341 | 170 | 114 | 65.8 | 35.2 | 16.8 | 8.54 | 7.70 |

Note: The above characteristics data are average values obtained Within three charge/discharge cycles not the minimum.

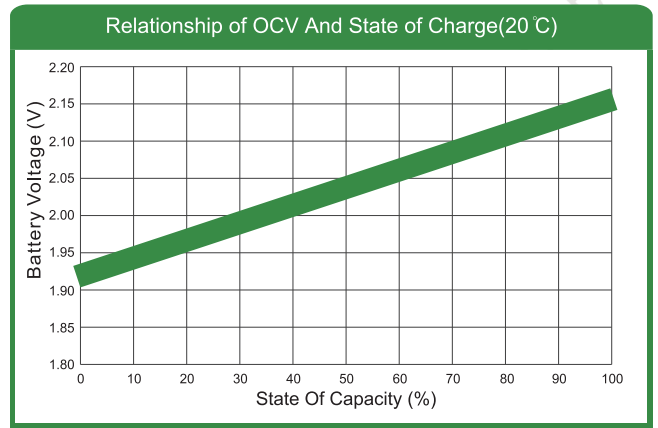
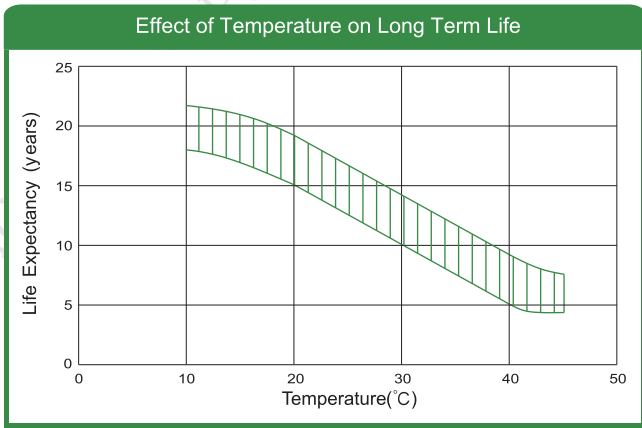
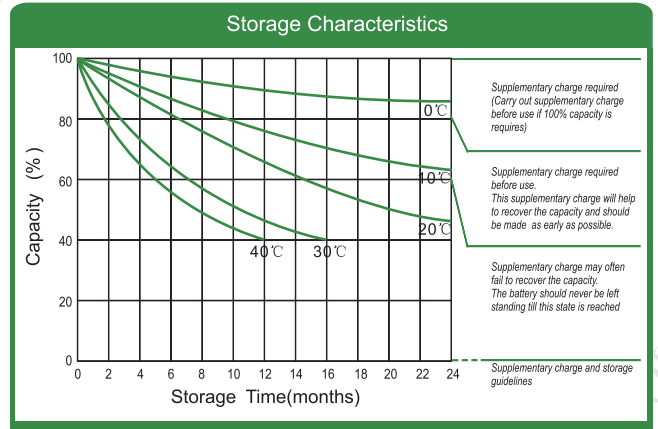
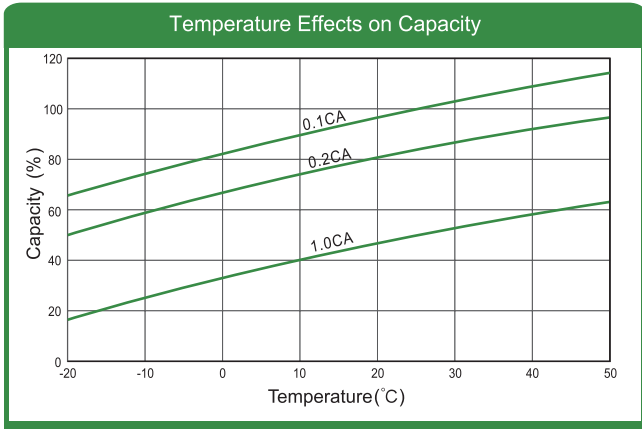
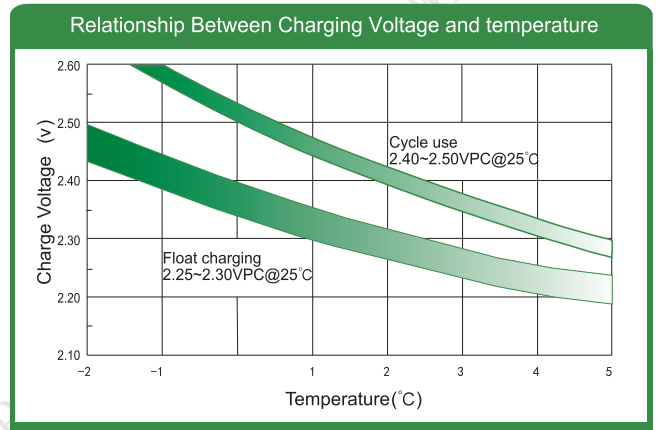
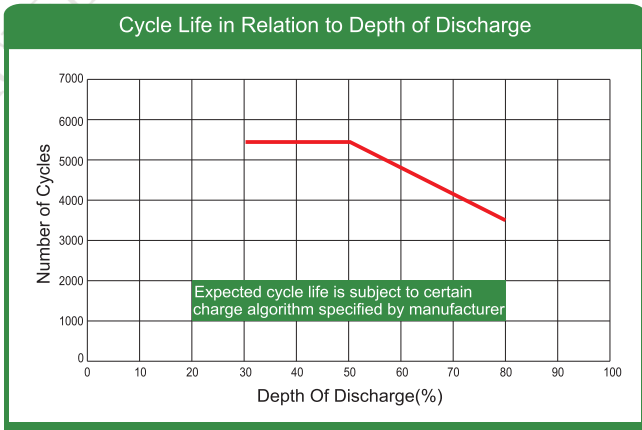
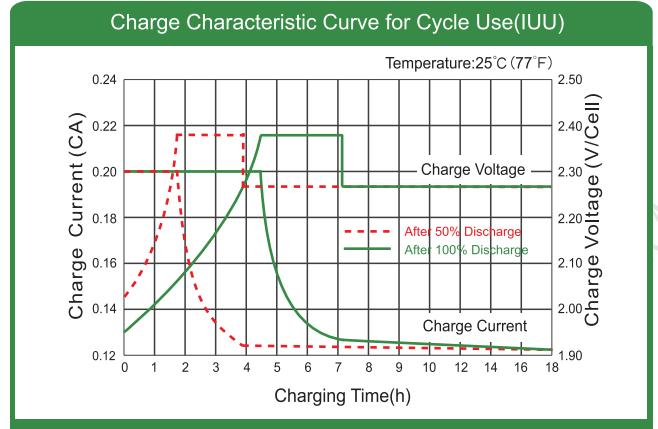
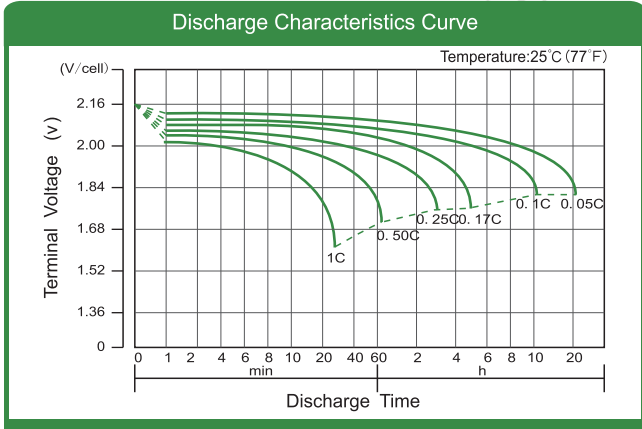

Factory address: Fukang Industrial Zone, Longnan, Ganzhou, Jiangxi Province, China.  
 Shenzhen Office: RM208-210, Building D, Tongju industrial Park, No.4, Longping West Road, Longgang District, Shenzhen.  
 TEL: +86-755-28288189      [sales@sfbattery.com](mailto:sales@sfbattery.com)      [www.sfbattery.com](http://www.sfbattery.com)