

HTG Series Battery

SPACEFLIGHT HTG Series Battery is hybrid GEL battery designed with deep cycle technology to give extra-durable cycle performance. HTG series battery with 12 years floating design life at 25°C.

Applications

- Solar and wind power systems
- Communication systems
- Uninterruptible power supplies
- Golf carts and buggies
- Alarm and security system
- Electric toy and wheelchairs, etc

General Features

- 12 years designed floating life(25°C)
- Non-spillable construction
- Sealed and maintenance-free
- Excellent recovery from deep discharge
- High density active materials plates
- Longer Life and low self-discharge

Standards

- Compliance with IEC, BS, JIS and EU standards.
- UL, CE Certified
- ISO45001,ISO9001 and ISO14001 certified production facilities

Specifications

Rated Voltage	12V	
Nominal Capacity	45Ah	(C ₁₀ , 10.5V)
Approx Weight	14kg±3%(30.86lbs)	
Terminal	F11	
Rated Capacity(25°C)	47 Ah	(20hr,2.35A,10.5V)
	45 Ah	(10hr,4.5A,10.5V)
	39 Ah	(5hr,7.8A,10.5V)
	28 Ah	(1hr,28A,9.6V)
Max.Discharge Current	450A(5s)	
Max.Charge Current	11.25A	
Internal Resistance(25°C)	Approx 7.5mΩ	
Operating Temp.Range	Discharge	-20~60°C(-4~140°F)
	Charge	-10~50°C(14~122°F)
	Storage	-20~60°C(-4~140°F)
Nominal operating temperature	25±5°C	
Charge Voltage @25°C(77°F)	Cycle Use	Initial Charging Current less than 11.25A. Voltage 14.4V~15.0V at 25°C(77°F)Temp. Coefficient -30mV/°C
	Standby Use	Initial Charging Current less than 11.25A. Voltage 13.5V~13.8V at 25°C(77°F)Temp. Coefficient -20mV/°C
Temperature effects on capacity	40°C (104°F)	103%
	25°C (77°F)	100%
	0°C (32°F)	86%
	-15°C (5°F)	65%
Self Discharge(25°C)	Capacity after 3 months storage	91%
	Capacity after 6 months storage	82%
	Capacity after 12 months storage	65%



Dimensions

unit:mm

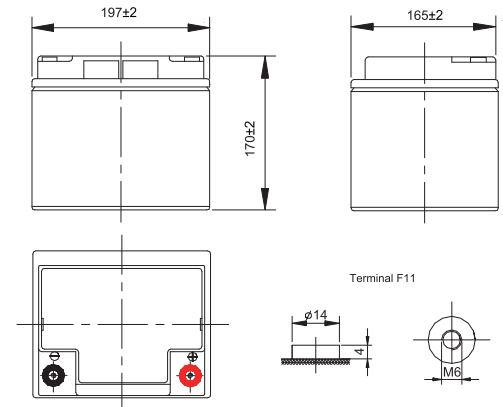

Length	197±2mm (7.76 inches)
Width	165±2mm (6.50 inches)
Container Height	170±2mm (6.69 inches)
Total Height	170±2mm (6.69 inches)

Battery Construction

Component	Positive plate	Negative plate	Container	Safety valve	Terminal	Separator	Electrolyte
Raw material	Lead dioxide	Lead	ABS(UL94-HB) or FR(UL94-V0)	Rubber	Copper	AGM	SiO ₂ +H ₂ SO ₄

Constant Current Discharge (Amperes) at 25°C(77°F)

E.V/Time	5min	10min	15min	30min	60min	3h	5h	10h	20h
1.60V	147	98.0	77.0	45.5	28.0	11.8	7.95	4.60	2.40
1.65V	136	93.0	74.1	43.7	27.2	11.6	7.91	4.57	2.39
1.70V	125	88.0	71.2	41.5	26.3	11.3	7.86	4.53	2.37
1.75V	114	83.0	67.1	39.6	25.4	11.0	7.80	4.50	2.35
1.80V	103	78.0	64.0	37.7	24.8	10.7	7.75	4.46	2.33

Constant Power Discharge (Watts/cell) at 25°C(77°F)

E.V/Time	5min	10min	15min	30min	45min	60min	2h	3h	5h
1.60V	260	173	144	83.0	70.0	55.6	32.6	23.0	15.0
1.65V	246	167	140	81.8	68.7	54.8	32.1	22.8	14.8
1.70V	232	161	135	80.5	67.4	54.0	31.6	22.5	14.7
1.75V	218	154	131	79.3	66.1	53.1	31.0	22.3	14.5
1.80V	209	148	126	78.0	64.8	52.3	30.5	22.0	14.4

Note: The above characteristics data are average values obtained Within three charge/discharge cycles not the minimum.

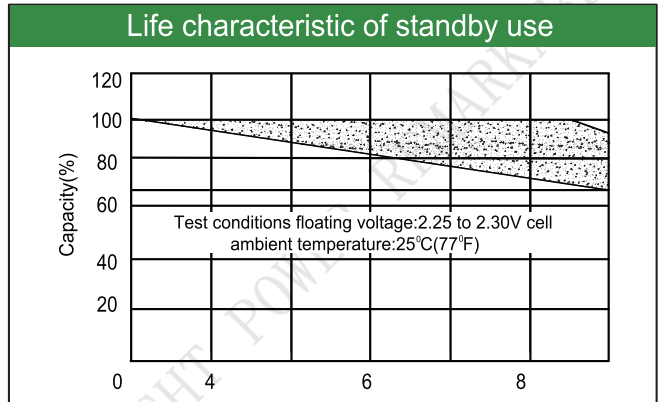
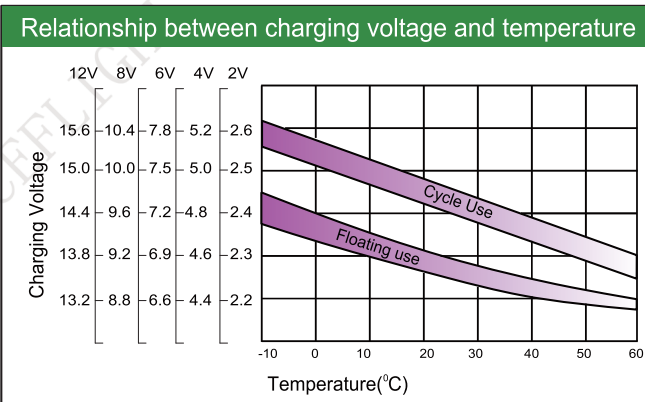
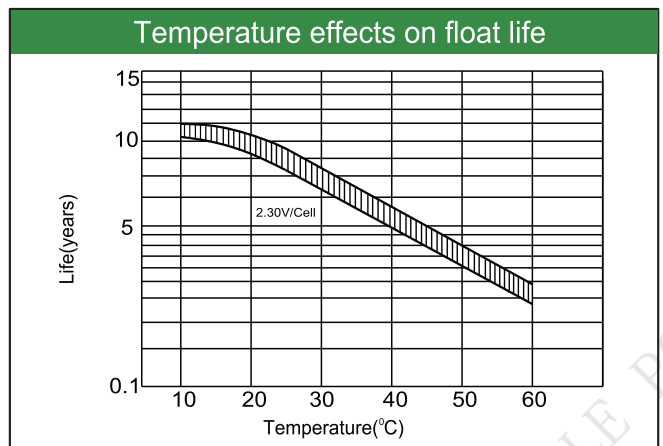
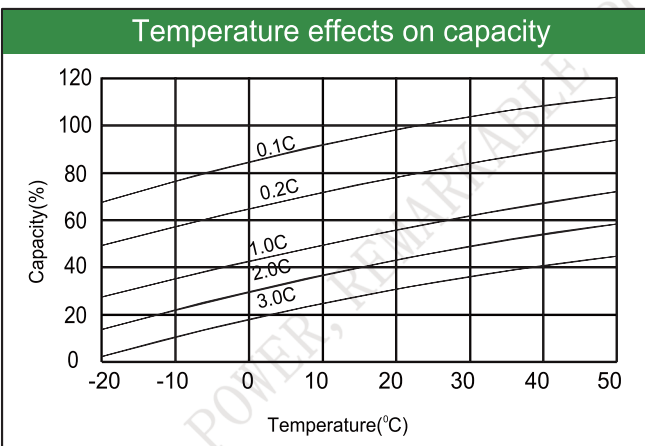
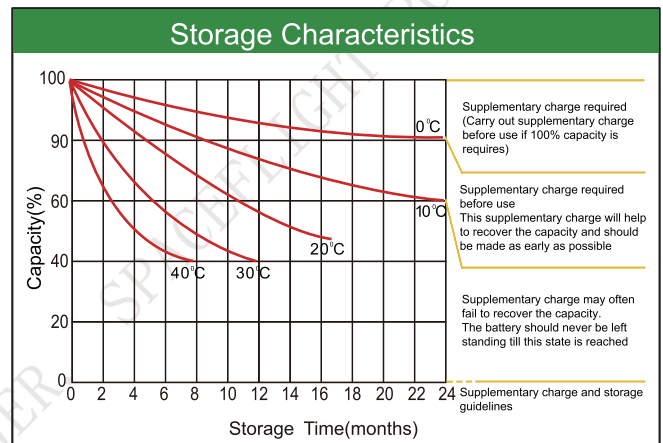
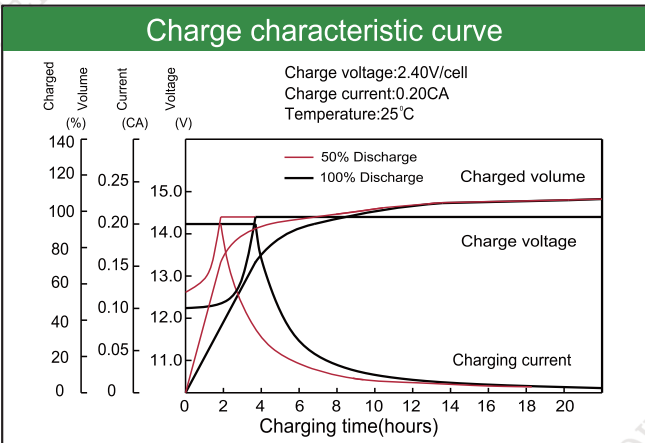
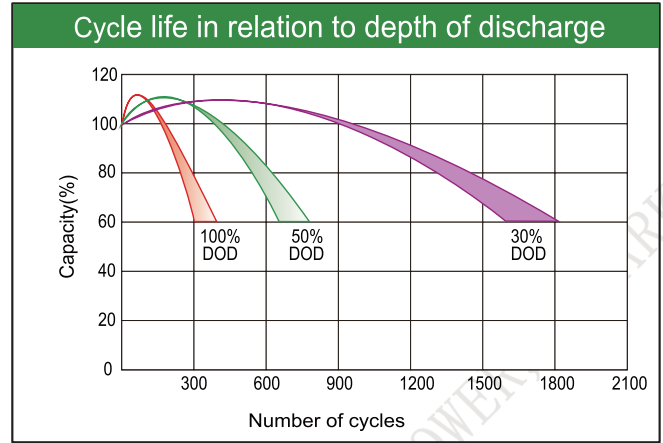
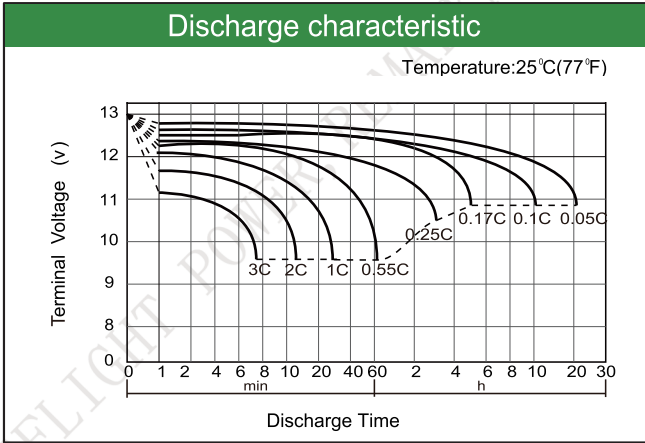

Factory address: Fukang Industrial Zone, Longnan, Ganzhou, Jiangxi Province, China.
 Shenzhen Office: RM208-210, Building D, Tongju industrial Park, No.4, Longping West Road, Longgang District, Shenzhen.
 TEL: +86-755-28288189 sales@sfbattery.com www.sfbattery.com